

Shore Projects Ltd.

“Reflection”

Public Art Project Artist/Artist Team Call

Call for Artists / Artist Teams Request for Design Proposals

Shore Projects Ltd. is pleased to invite interested Artist/Artist Teams to submit design proposals for the creation of public art as part of The Shore’s development. The proposed artwork *“Reflection”* will engage and inspire the residents and visitors within the development and its landscape environment.

This is a two staged artist/artist team call.

The budget for the public art project is \$75,000 (CDN, including all applicable taxes)

Email Submission Deadline: Thursday, August 15th, 2013

The following project terms of reference provides information on the proposed The Shore Residential Development, including: the area and site history, project location, public art opportunity areas (i.e., conceptual approach, theme, etc.), budget, artist presentation requirements, selection panel, process and key contacts.

Email, mail, courier or hand deliver a PC/MAC compatible CD/DVD or USB flash drive of your submission package to: bradj@adera.com

Or

Shore Projects Ltd.
Suite 2200, 1055 Dunsmuir Street
Vancouver, B.C. V7X 1K8

Re: The Shore Public Art Project – *“Reflections”*

THE SHORE PROJECT LTD. PUBLIC ART CALL

Shore Projects Ltd. is pleased to invite interested Artist/Artist Teams to submit design proposals for the creation of public art that is to be integrated as part of The Shore's development.

PUBLIC ART PROJECT LOCATION

The location of the artwork is to be integrated with the central water feature. It is important that the completed artwork can be easily viewed, realized and noticed by pedestrians, cyclists and motorists.

The artwork's location is noted on the landscape plan pages 7 and 8. Larger scaled copies of these and other plans will be made available to the Artist/Artist Team.

CONCEPTUAL FRAMEWORK & PUBLIC ART THEME - "REFLECTION"

Conceptually the proposed artwork theme "Reflection" will mirror or echo the water feature's character including the water's movement and flow that showcases west coast forest landscapes. The artwork design is to be a bold vertical element (at least 20 feet high) that is the focal point of the central water landscape. The theme permits the artist to showcase water through bold visual and vertical artwork features and structures. The artwork can utilize a variety of materials: natural elements, lighting, glazing, concrete, metal, lighting or similar materials and/or can be a functional element of the location, setting or entryway. The artwork should also support and help showcase The Shore's West Coast building design theme.

The visual artwork concept is to be identified by invited Artists/Artist Teams, and presented as part of their design scheme proposals at the panel meeting presentations.

SCOPE OF WORK

The Artist/Artist Team will be entirely responsible for the design, fabrication and installation of public art for this project. It is recognized that all or some portion of the artwork may be integrated and constructed as part of the development, where the actual work will be supervised by the Artist/Artist Team versus their actually fabricating or installing it. For example, finishing of the artwork as part of the water feature (i.e. special rock) may be outside of the scope/design of the landscape architect and should be accounted for in the art project cost. The Artist/Artist Team will work with the project design team to ensure that the completed artwork meets all engineering and structural standards and requirements (i.e., certified engineering drawings). Consultation with the project contractor, project engineer and/or landscape architect may be required.

PROJECT GUIDELINES

Budget

\$75,000 CND is inclusive of all costs including artist and engineering fees, travel, design, artwork fabrication, public workshops, transport, site preparation, installation, all applicable taxes, insurance, Workers' Compensation Board coverage and contingency (5%), as well as any other costs associated with this public art project.

The Artist/Artist Team will be responsible for a General Public Liability Insurance Policy in the minimum amount of two million dollars.

The second stage short listed Artist/Artist Team will be provided with \$2,000 for presentation of conceptual design proposals that include detailed drawings, samples, researched budget and project timeline.

As part of the conceptual design process, the Artist/Artist Team will have an opportunity to consult with Brad Jones, VP Development (Tel: 604.684.8277 or email: bradj@adera.com) and the project's

landscape architect Michael Patterson, Perry & Associates (604.738.4118 or email: mp@perryandassociates.ca).

On July 9th, 2013, 10 AM, an artist information meeting on the project will be held at Adera offices, 555 Burrard St, Tower II, Suite 1165, 'Bentall Room', Vancouver, BC.

Important Dates

Tasks	Date
Call Announcement and Distribution	July 1 st , 2013
Artist Information Meeting	July 9 th , 2013, 10 PM, Adera Office, 555 Burrard Street, Tower II, Suite 1165, 'Bentall Room'. <i>(The Shore project and design team will be present)</i>
Deadline for 1 st Stage Artist/Artist Team Submissions	August 15 th , 2013 4pm
Selection Panel reviews Artist/Artist Team Submissions	August 16 th to 22 th , 2013
Artist/Artist Team Shortlist Announced	August 22 nd , 2013
Short Listed Artist/Artist Team Final Design/Magquette Submission Deadline	September 23 rd , 2013
Short Listed Artist/Artist Team Panel Presentation	September 27 th to October 3 rd , 10 AM to 4:30 PM, Adera Office, Meeting Room <i>(Artist Presentation, Date and Time to be Determined & Artists Notified)</i>
Artist/Artist Team Selection Announced	November 4 th , 2013
Development – Artist Contract Signed	November, 2013
Public Art Integration & Installation	2014 - 2015

PROJECT CRITERIA

The Selection Panel is seeking an Artist/Artist Team whose proposal best responds to the following criteria:

The artwork:

- Must strongly address the "Conceptual Framework/Public Art Theme" noted.
- Should complement the development and site entry, design and natural materials.
- Should be iconic and highly visible.
- Location should not impede or cause sight line problems for pedestrians and bike riding traffic or motorists.
- Must be made of durable materials, comply with public safety standards, be vandal, theft and graffiti resistant and be easily maintainable over the long term.

The selected Artist/Artist Team:

- Must research, consult and/or work with The Shore staff, project design team and contractor.
- Will consult with a structural/electrical engineer as well as an art conservator regarding the final design, fabrication and installation plans for the proposed artwork, and provide certified drawings as required.
- Will be responsible for consultation and collaboration with the Adera staff, Engineering and Design Professionals, and other relevant personnel where necessary.

SELECTION PROCESS

Selection Stages

A two-stage Artist/Artist Team selection process will be used for the commissioning of public art for this opportunity.

The Artist/Artist Team will describe the artist's concept in detailed drawings, the intended approach to develop the concept, and include a proposed budget (artist fees and construction component) and a working schedule. It should outline the maintenance requirements of the proposed artwork and list intended contractors and consultants, if required.

Selection Panel

A Selection Panel composed of practicing arts professionals and members of the community will be established by Adera with advice from the North Vancouver Public Art Program. The Selection Panel reserves the right not to select any of the artists.

In addition, Adera staff and Project's Design Team will provide technical advice and assistance to the Selection Panel. They may attend the Selection Panel meeting and be non-voting members of the Panel.

Selection Approvals

The Selection Panel will select the proposal that, in its judgment best meets the criteria as presented. Upon approval, the selected Artist/Artist Team will be announced and enter into a public art contract with Adera. The Selection Panel reserves the right not to select any of the artists for this call.

Contract

This Invitation Call for Artist/Artist Teams is simply an invitation for presentation of public art design proposals for the convenience of all parties. It is not a tender and no obligations of any kind will arise from this invitation call or any submissions. Adera may negotiate changes to any terms or prices, and may negotiate with one or more Artists or may permit the submission of applications from other parties.

A Contract between the successful Artist/Artist Team and Adera will be drawn up. The final work and all documentation will become the property of Shore Projects Ltd. Proof of insurance and related WCB coverage must be provided upon signing the contract.

EVALUATION CRITERIA

Each candidate will be evaluated on the basis of the following:

Artistic Experience / Expression

- Application compliance.
- Excellence of concept.
- Appropriateness of the proposed artwork in relation to the scope of work.
- Flexibility of proposal in respect to unknown project factors.

Technical Skill / Methodology

- Demonstrated ability to work with proposed tasks.
- Demonstrated ability to work with Adera staff and project designers and contractor.
- Sound problem-solving abilities.

Management Skills

- Understanding of project intent.
- Realistic budget and schedule.
- Good communication and presentation skills.
- Availability to work within the given time frame.

STAGE 1: SUBMISSION REQUIREMENTS

- Artists/Artist Teams are asked to submit up to fifteen (15), 8 ½" x 11 ½" pages of information as listed below on one PDF Acrobat format file. Please do not secure the PDF file as extract an image may need to be extracted for presentation to the Selection Panel. Note: It is recommended that the entire PDF be in landscape format as images will be presented to the Selection Panel as horizontal projections.
- Photos of artwork to be captioned on the same page with information as noted below.

Page 1: Letter of Interest (1 page)

- This letter explains your interest in the project, provides a brief perspective on your practice and the materials you generally work with. Please cite any relevant experience.
- If submitting as a team, the letter should include a description of how the team works together, and any previous collaborative work experience. Your letter is to confirm that you have read, accept and will abide by the terms and conditions outlined herein.

Pages 2 and 3: Approach to the Project (max. 2 pages)

- Describe and/or illustrate your approach or possible idea for artwork for this project.

Pages 4 and 5: Artist's/Artist Team's Resume (max. 2 pages)

- Include a professional artist's resume. For team applications please include resumes for all team members (and contact information including email addresses). All team members to have confirmed participation prior to submission.

Pages 6 to 15: Images of Artist's / Artist Team's Work

- Submit up to 10 examples of your past artwork. We recommend representing one artwork on each page.
- Please include a caption for each artwork with information including: artist's name, artwork title, completion date, medium/materials, dimensions, total budget and project contact information. Describe if the artwork is animated: State your role in the creation of the artwork.

INFORMATION MEETING

A general information meeting on The Shore Public Art Project will take place on July 9th, 2013, 10 AM, at Adera, 555 Burrard Street, Tower II, Suite 1165, 'Bentall Room', Vancouver, BC. Please RSVP your attendance to: Kari Huhtala, Project Public Art Consultant at khuhtala@shaw.ca

STAGE 2: SHORT LISTED ARTIST/ARTIST TEAM SUBMISSIONS

- A maquette is optional at the time of presentation to the Selection Panel, however it would enhance your presentation. The Artist/Artist Team must however, provide sufficient detailed information for the Selection Panel to make an informed decision.
- Samples that adequately describe materials and methods to be used.
- Additional support material, photographs, proposed project budget, fabrication and related support material can be presented at the Selection Panel meeting.

All short listed individual Artists or Artist Teams will be provided with \$2,000 including taxes, in compensation for the research development and presentation of conceptual design proposals that include detailed drawings, material samples, preliminary project budget and timeline. Participating Artist or Artist Teams are asked to submit a letter of intent to submit together with an invoice for \$2,000 on or by September 23rd, 2013. Funds will be disbursed upon completion of the presentation and the receipt of all required submission materials. The invoice must have a unique invoice number, must be inclusive of taxes, and be addressed to the address noted below.

EMAIL SUBMISSION DEADLINE

**Shore Projects Ltd. "Arrival" Public Art Project
Attention: Brad Jones, VP Development,
Suite 2200, 1055 Dunsmuir Street, Vancouver, B. C. V7X 1K8**

Submissions sent to bradj@adera.com at Shore's Office by Friday, August 15th, 2013. Office hours 8:00 am to 4:00 pm PST.

As a backup, a PC/MAC compatible CD/DVD or USB flash drive may be mailed or delivered to also arrive by the above deadline.

QUESTIONS

Direct all general enquiries to Kari Huhtala, Project Public Art Consultant by email: khuhtala@shaw.ca or Tel. 604 613.0319. Direct all technical questions to Brad Jones, Adera: email: bradj@adera.com or Tel. 604.684.8277.

OTHER TERMS & CONDITIONS

Shore Projects Ltd. will not be liable for any claims incurred by the Artist or Artist Team for any activities related to or arising from this invitation only call.

An Artist or Artist Team must disclose in its submission any actual or potential conflicts of interest and existing business relationships it may have with Shore Projects Ltd., its officials or employees.

Shore Projects Ltd. thanks all invited Artists and Artist Teams who have agreed to participate in this call.

THE SHORE DEVELOPMENT LANDSCAPE PLAN AND PUBLIC ART PROJECT LOCATIONS

Note: Larger scaled copies of this and other plans will be made available.

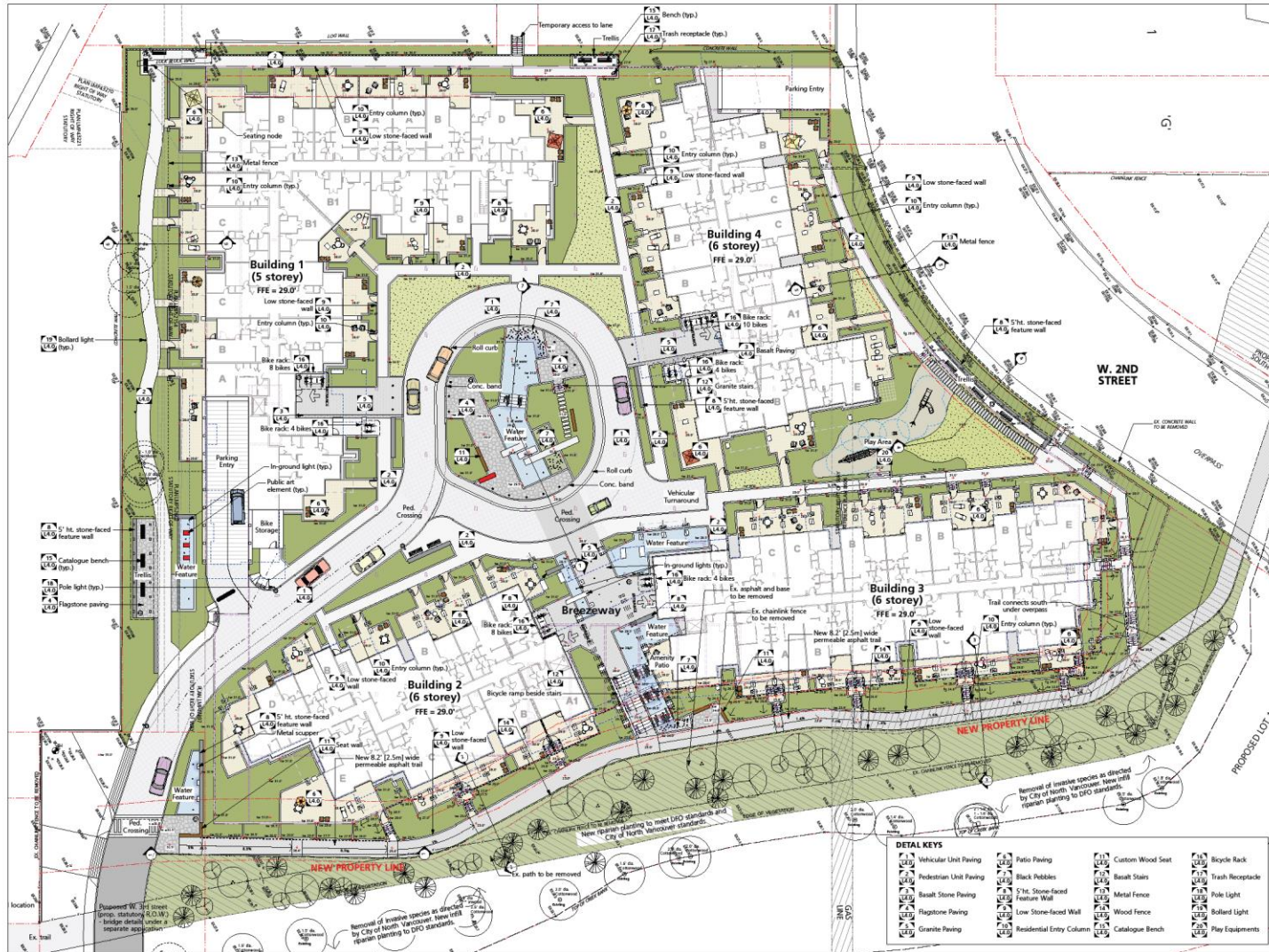

P+A
 Piny & Associates
 Landscape Architecture
 Site Planning
 Suite 200 1700 W 4th Avenue
 Vancouver, BC V6J 4G2
 T 604.728.4118
 F 604.728.4112
 www.pinyandassociates.ca

3 Re-issue for ADP Panel 6/12/12
 2 Issue for ADP Panel 09/16/2012
 1 Issue for ADP 09/16/2012
 Revision No. Data

Client: Adera

Project Title: Creek Crossing

Drawing Title: Landscape Key/Grading Plan

Project North: Drawn By: YI
 Checked By: MAP
 Scale: 1" = 20'-0" @ Arch D Job No.: 11-024
 Sheet No.:

L1.0

THE SHORE DEVELOPMENT PUBLIC ART PROJECT LOCATION

Note: Larger scaled copies of this and other plans will be made available.

